

IF IN DOUBT PLEASE ASK

ITEM NO.	PART NUMBER	DESCRIPTION	QTY.
1	TOW EYE 50mm JOST 57394	TOWEYE	1
2	CM100-002-001	DRAW BEAM	1
3	CM100-002-002	TOW EYE DOUBLER	1
4	CM100-002-003	TOW EYE DOUBLER	1
5	CM100-002-004	END CAP	2
6	CM100-002-005	DOUBLER	2
7	CM100-002-006	HANDLE	4
8	CM100-002-007	BOLT PLATE	1
9	CM100-002-008	BOLT PLATE GUSSET	4
10	CM100-002-009	INNER CAP	1

WELDMENT WEIGHT*		
SW MODEL WEIGHT +6% TOL =	<b>104</b>	<b>KG</b>
* Weight of weldment/assembly is only what is shown in the drawing and is for manufacturing logistics purposes only!		
ASSEMBLY WEIGHT*		
SW MODEL WEIGHT +6% TOL =	<b>102</b>	<b>KG</b>
* Weight of weldment/assembly is only what is shown in the drawing and is for manufacturing logistics purposes only!		

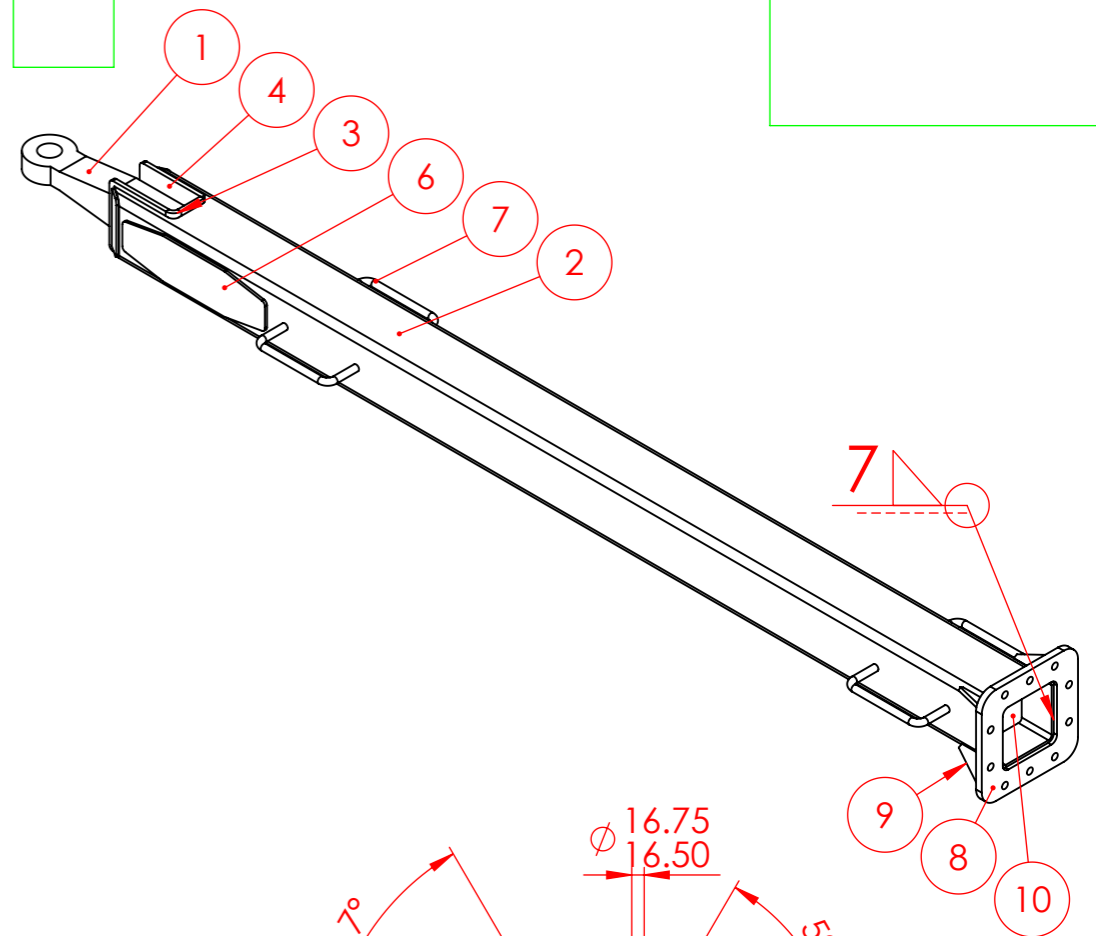
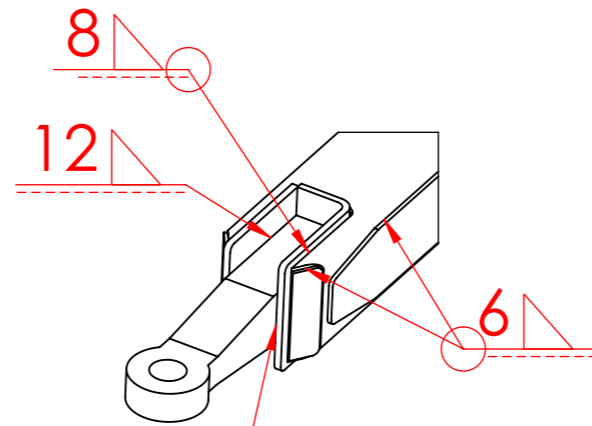

**WELDMENT VIEW  
BOLT PLATE AT 20mm THICKNESS**

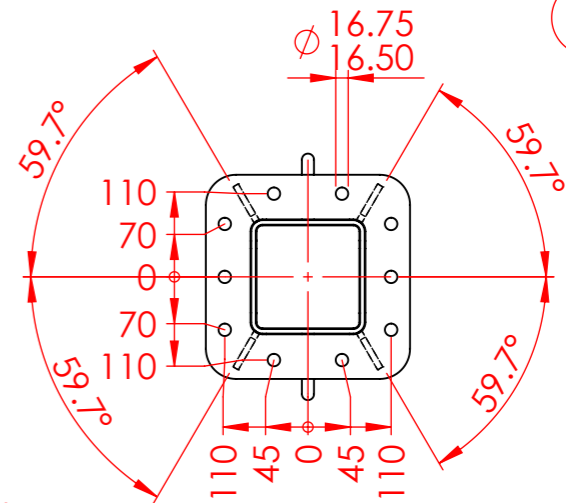
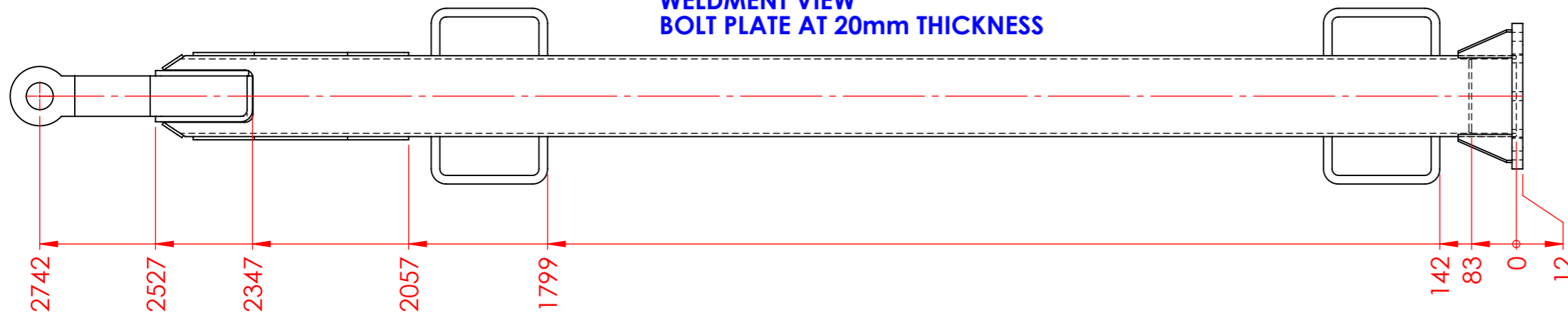

**MACHINED VIEW  
BOLT PLATE AT 16mm THICKNESS**

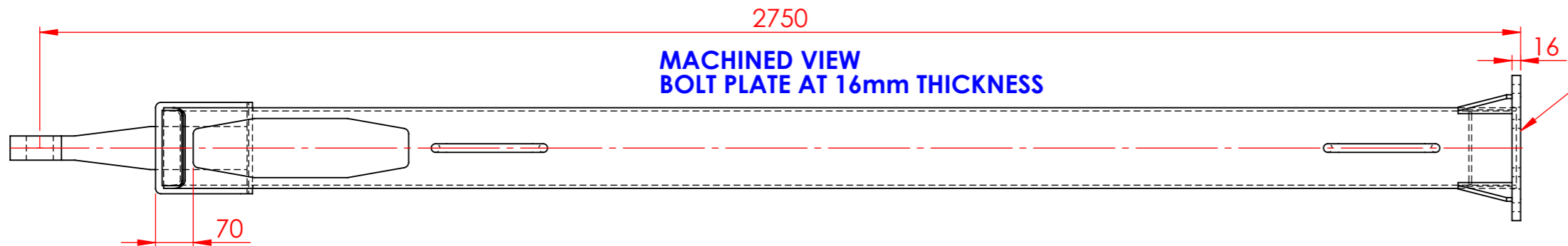

**LINE BORE THIS FACE DOWN TO ACHIEVE LENGTH MEASUREMENT AND FLAT BOLTING FACE THEN LINE BORE BOLT HOLES**

PART NUMBER:	<b>CM100-002</b>
DESCRIPTION:	<b>5.5m PUSH/PULL 2 PIECE</b>
QTY:	<b>2 - OFF</b>

**UNLESS OTHERWISE STATED**  
 GENERAL TOLERANCES: 0.00 = ± 0.05, 0.0 = ± 0.2, 0 = ± 0.5, ANGLES: 0 = ± 0.5°  
 THIRD ANGLE PROJECTION SURFACE FINISH (µm): 1.6  
 THIS DRAWING IS © COPYRIGHT AND IS THE PROPERTY OF TIDD ROSS TODD LTD. IT IS FURNISHED TO YOU FOR CONFIDENTIAL INFORMATION PURPOSES ONLY AND IS NOT TO BE DISCLOSED TO ANYONE ELSE OR USED FOR MANUFACTURING PURPOSES WITHOUT THE EXPRESS WRITTEN PERMISSION OF TIDD ROSS TODD LTD.

REV	DATE	COMMENT	NAME



**TIDD ROSS TODD LTD**  
 48 Maui Street, Hamilton, New Zealand  
 Phone: +64 7 849 4839  
 Email: trt@trt.co.nz  
 Website: trt.co.nz  
 ISO9001:2015

NAME	DATE	TITLE:
DRAWN JM	26/07/22	5.5m PUSH/PULL 2 PIECE
CHK'D -	-	
APPV'D -	-	
DO NOT SCALE DRAWINGS IN mm's	<b>STATUS - M</b>	SHEET 1 OF 1 SCALE: 1:10
		DWG NO. CM100-002 REVISION <b>A</b>

IF IN DOUBT PLEASE ASK

NIKAU PUSH PULL BAR  
17 Feb 2023  
Job No 186375 - JC

ITEM NO.	PART NUMBER	DESCRIPTION	QTY.
1	CM100-003-001	SPACER BEAM	1
2	CM100-003-002	FLITCH	2
3	CM100-002-006	HANDLE	4
4	CM100-002-007	BOLT PLATE	2
5	CM100-002-008	BOLT PLATE GUSSET	8
6	CM100-002-009	INNER CAP	2

ASSEMBLY WEIGHT*		
SW MODEL WEIGHT +6% TOL =	<b>100</b>	<b>KG</b>
* Weight of weldment/assembly is only what is shown in the drawing and is for manufacturing logistics purposes only!		

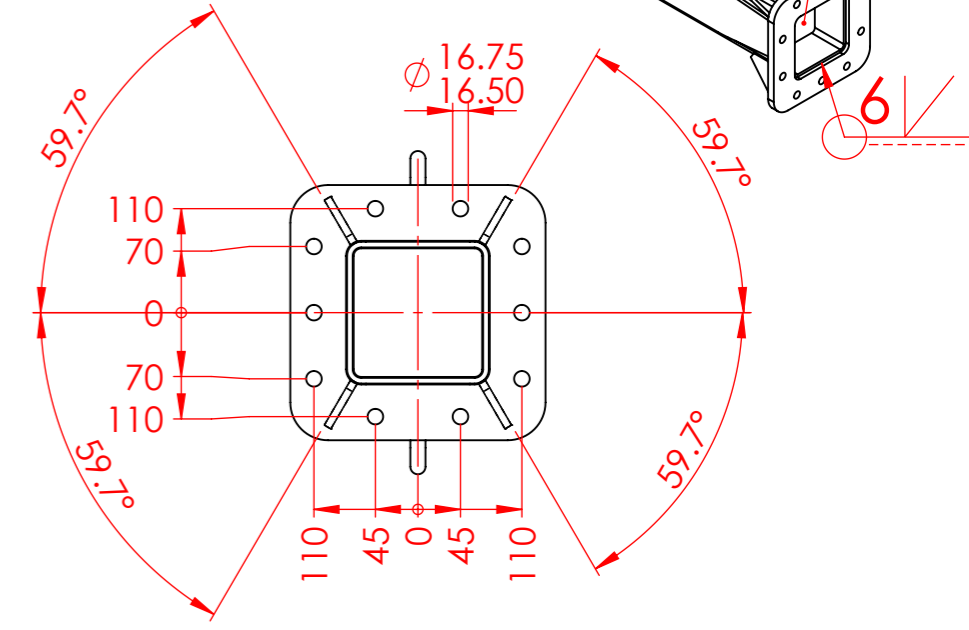
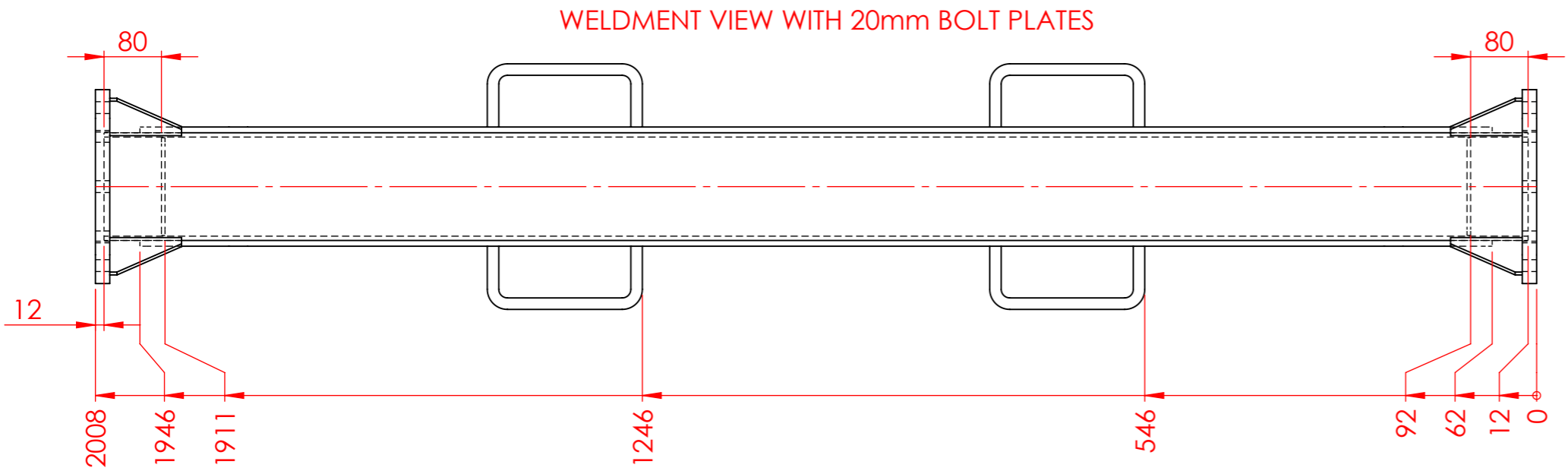
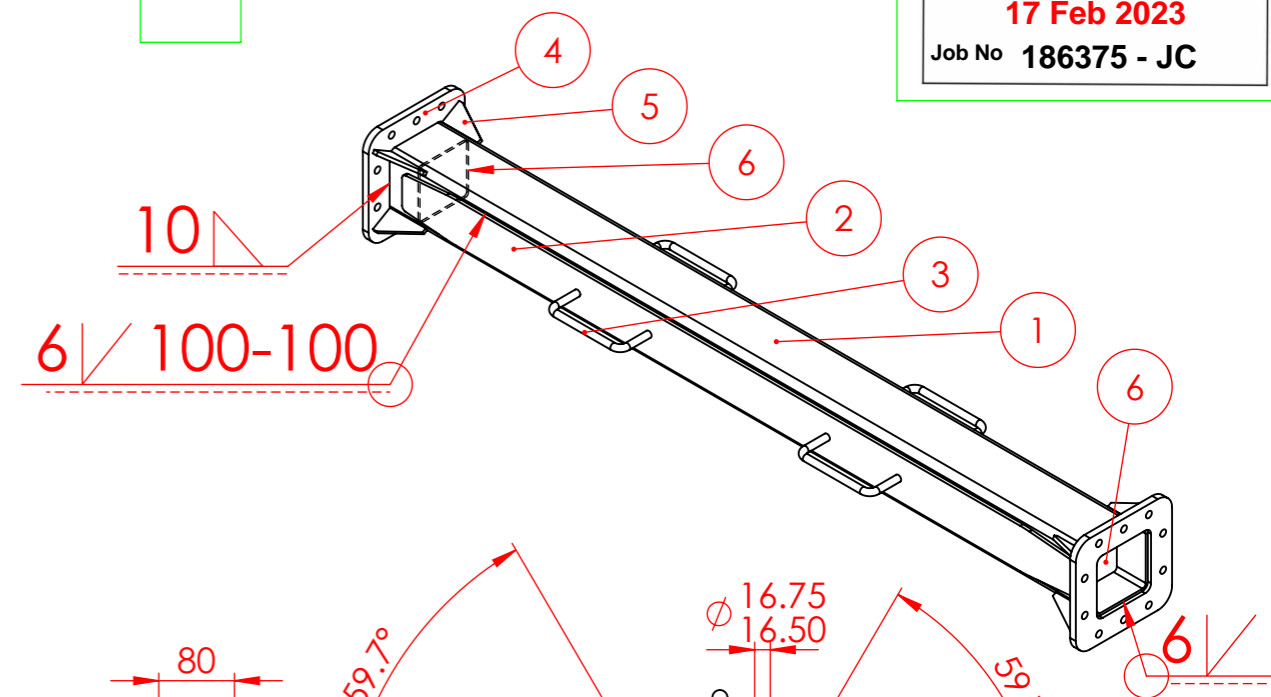

**LINE BORE BOTH ENDS EVENLY TO APPROX THICKNESS SHOWN TO ACHIEVE CORRECT OVERALL DIMENSION AND DRILL HOLES FOR THE BOLTS**

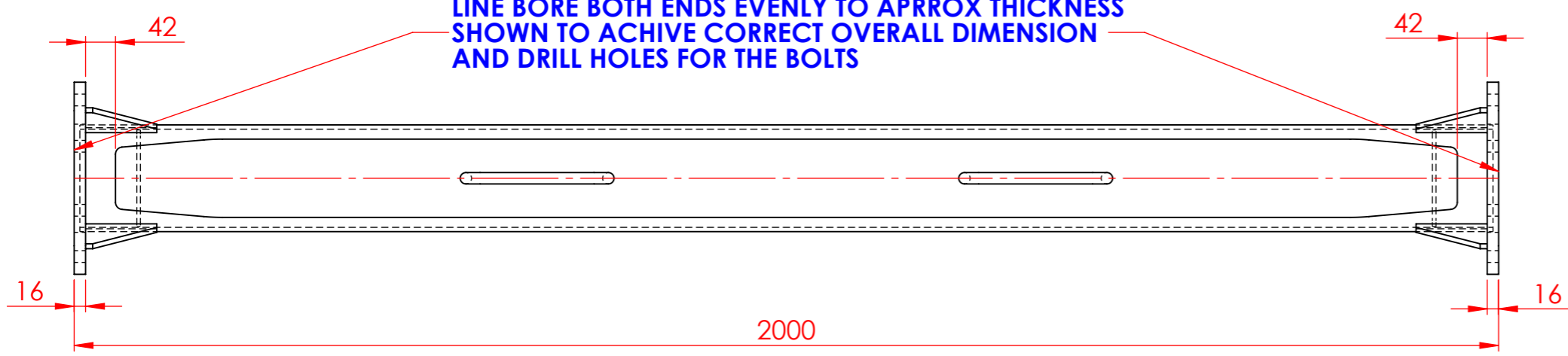

PART NUMBER:	<b>CM100-003</b>
DESCRIPTION:	<b>PUSH/PULL SPACER</b>
QTY:	<b>1 - OFF</b>

**UNLESS OTHERWISE STATED**  
GENERAL TOLERANCES  
0.00 = ± 0.05  
0.0 = ± 0.2  
0 = ± 0.5  
ANGLES  
0 = ± 0.5°  
THIRD ANGLE PROJECTION  
SURFACE FINISH (µm)  
1.6  
THIS DRAWING IS © COPYRIGHT AND IS THE PROPERTY OF TIDD ROSS TODD LTD.  
IT IS FURNISHED TO YOU FOR CONFIDENTIAL INFORMATION PURPOSES ONLY AND IS NOT TO BE DISCLOSED TO ANYONE ELSE OR USED FOR MANUFACTURING PURPOSES WITHOUT THE EXPRESS WRITTEN PERMISSION OF TIDD ROSS TODD LTD.

REV	DATE	COMMENT	NAME



**TIDD ROSS TODD LTD**  
48 Maui Street, Hamilton,  
New Zealand  
Phone: +64 7 849 4839  
Email: trt@trt.co.nz  
Website: trt.co.nz  
ISO9001:2015

	NAME	DATE
DRAWN	JM	26/07/22
CHK'D	-	-
APPV'D	-	-

TITLE:	<b>PUSH/PULL SPACER</b>	
SHEET 1 OF 1	DWG NO.	REVISION
SCALE:1:8	<b>CM100-003</b>	<b>A</b>